

# SDL vs. TDL For My Exterior Door - How Do I Choose?

Scan for More Information



Simpson has been manufacturing divided lite doors for over a century and provides two basic construction types for exterior doors: Simulated Divided Lite (SDL) and True Divided Lite (TDL). When used with clear glass, it is virtually impossible for a homeowner to tell the difference. So what is the difference, and why should it matter when you order a Simpson door? Check out the reasons below.



## SIMULATED DIVIDED LITE (SDL)

Features a single glass unit with bars applied to the glass surface.

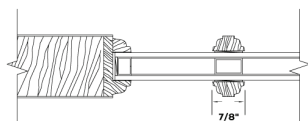

SDL WITH IG IN OVOLO PROFILE

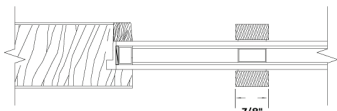

SDL WITH IG IN SHAKER PROFILE

## TRUE DIVIDED LITE (TDL)

Features multiple glass units divided by muntin bars.

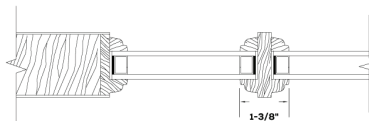

TDL WITH IG IN OVOLO PROFILE

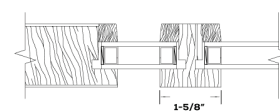

TDL WITH IG IN SHAKER PROFILE

✓	<b>Simpson Recommends</b>	
7/8"	<b>Standard Bar Width</b>	1-3/8" (Ovolo), 1-5/8" (Shaker)
✓ 1-3/8", 1-1/8"	<b>Optional Bar Widths</b>	N/A
✓ In 1 spot	<b>Tempered Glass Etching/Bug</b>	On each piece of glass
✓ One side of the door and only on the perimeter glass bead	<b>Nail Holes to Be Filled by Finisher</b>	One side of the door with multiple on each bar
✓	<b>Smooth to Semi-Smooth Surface Textures</b>	✓
Triple-Glazed between two pieces of clear glass, no shadow spacer	<b>Heavy Surface Textures</b>	Available
✓	<b>More Energy Efficient</b>	

FOR MORE INFORMATION, VISIT [SIMPSONDOOR.COM/DIVIDEDLITE](https://www.simpsondoor.com/dividedlite)

